

Upper Level

1. Welcome Desk
2. Upper Foyer – Entrance to the track
3. Women's Changing Room
4. Men's Changing Room
5. Child Minding
6. Café (Opening late Spring)
7. Gymnasium
8. Fitness Centre – Overlooking Pool
9. Fitness Centre cont.

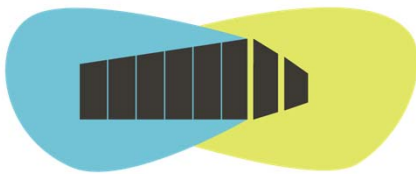

**ZATZMAN
SPORTSPLEX**

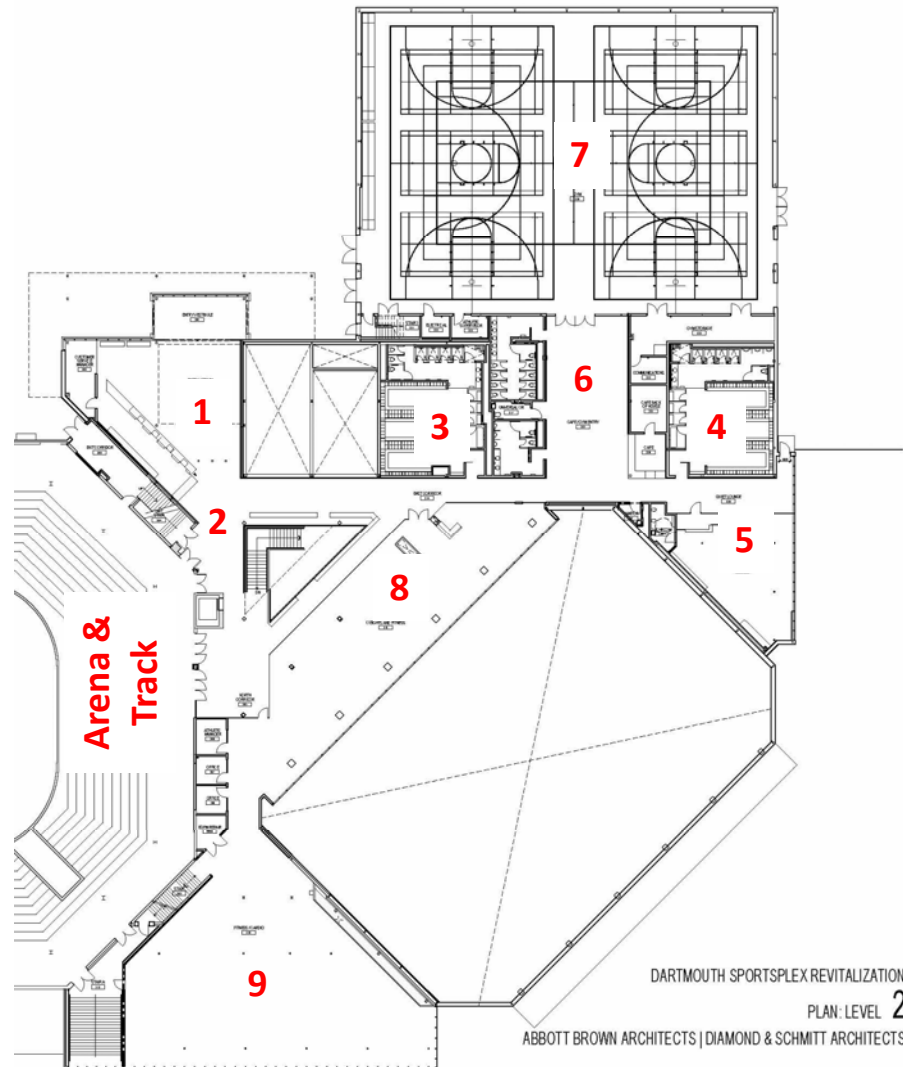

Lower Level

1. Lower Lobby
2. Racquetball Court
3. Squash Court
4. Fitness Studio (Windmill)
5. Fitness Studio (Shore)
6. Fitness Studio (Victoria)
7. Nova Room (Pool Classroom)
8. Women's Changing Room
9. Universal Changing Room
10. Men's Changing Room
11. Swimming Pool – Access through changing rooms
12. Boxing Studio
13. Hallway to Meeting Rooms
14. Entrance to Arena Team Rooms

